

# STAINLESS STEEL WIREWAY SYSTEMS

## Zanara



### Wireway Standard Sizes

Code	Size	Length
WW-22	50x50	3m
WW-33	75x75	3m
WW-44	100x100	3m
WW-64	150x100	3m
WW-66	150x150	3m

### Wireway Non Standard Sizes

Code	Size	Length
WW-84	200x100	3m
WW-96	225x150	3m
WW-124	300x100	3m
WW-126	300x150	3m
WW-184	450x100	3m



### Wireway Divider

Code	Size
WW-33-D	75x75
WW-44-D	100x100
WW-64-D	150x100
WW-66-D	150x150

## FRONT COVER FITTINGS

### Front Cover Tee

Code	Size
FCT-22	50x50
FCT-33	75x75
FCT-44	100x100
FCT-64	150x100
FCT-66	150x150



### Front Cover Bend 90 Deg

Code	Size
FCB90-22	50x50
FCB90-33	75x75
FCB90-44	100x100
FCB90-64	150x100
FCB90-66	150x150



### Front Cover Bend 45 Deg

Code	Size
FCB45-22	50x50
FCB45-33	75x75
FCB45-44	100x100
FCB45-64	150x100
FCB45-66	150x150



## EXTERNAL COVER FITTINGS

### External Cover Tee

Code	Size
ECT-22	50x50
ECT-33	75x75
ECT-44	100x100
ECT-64	150x100
ECT-66	150x150

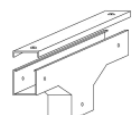

### External Cover Bend 90 Deg

Code	Size
ECB90-22	50x50
ECB90-33	75x75
ECB90-44	100x100
ECB90-64	150x100
ECB90-66	150x150

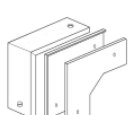

### External Cover Bend 45 Deg

Code	Size
ECB45-22	50x50
ECB45-33	75x75
ECB45-44	100x100
ECB45-64	150x100
ECB45-66	150x150

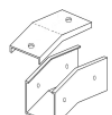

## INTERNAL COVER FITTINGS

### Internal Cover Tee

Code	Size
ICT-22	50x50
ICT-33	75x75
ICT-44	100x100
ICT-64	150x100
ICT-66	150x150

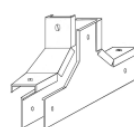

### Internal Cover Bend 90 Deg

Code	Size
ICB90-22	50x50
ICB90-33	75x75
ICB90-44	100x100
ICB90-64	150x100
ICB90-66	150x150

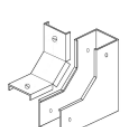

### Internal Cover Bend 45 Deg

Code	Size
ICB45-22	50x50
ICB45-33	75x75
ICB45-44	100x100
ICB45-64	150x100
ICB45-66	150x150



### Flange Adaptor Fix Lid

Code	Size
FA-FL-22	50x50
FA-FL-33	75x75
FA-FL-44	100x100
FA-FL-64	150x100
FA-FL-66	150x150



### Flange Adaptor Removable Lid

Code	Size
FA-RL-22	50x50
FA-RL-33	75x75
FA-RL-44	100x100
FA-RL-64	150x100
FA-RL-66	150x150



### Square Reducer

Code	Size
SQR-33-	75x75
SQR-44-	100x100
SQR-64-	150x100
SQR-66-	150x150



### End Cap

Code	Size
EC-22	50x50
EC-33	75x75
EC-44	100x100
EC-64	150x100
EC-66	150x150

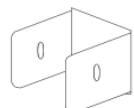

### Flange Coupling

Code	Size
FC-22	50x50
FC-33	75x75
FC-44	100x100
FC-64	150x100
FC-66	150x150

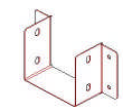

### Straight Coupling

Code	Size
SC-22	50x50
SC-33	75x75
SC-44	100x100
SC-64	150x100
SC-66	150x150

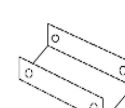

### Cover Fixing Kit

Code	Size
CFK-22	50x50
CFK-33	75x75
CFK-44	100x100
CFK-64	150x100
CFK-66	150x150

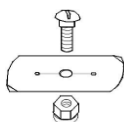

### Screw Set

Code	Size
SS	All



Material Type: 304 Stainless Steel  
Material Finish: Satin  
Gauge: 1.2 mm (18G)

All Wireways & Fittings supplied complete with Coupler and Fixing Screws.

# STAINLESS STEEL APEX WIREWAY SYSTEMS

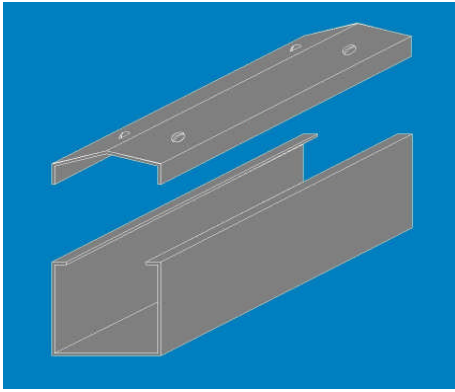

**10 DEGREE COVER LID**

## Apex Wireway-Standard Sizes

Code	Size
AP-WW-33	75x75
AP-WW-44	100x100
AP-WW-64	150x100
AP-WW-66	150x150

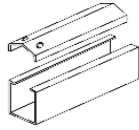

## Apex Perforated Wireway

Code	Size
AP-WWP-33	75x75
AP-WWP-44	100x100
AP-WWP-64	150x100
AP-WWP-66	150x150

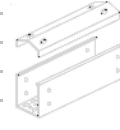

## FRONT COVER FITTINGS

### Apex Front Cover Tee

Code	Size
AP-FCT-33	75x75
AP-FCT-44	100x100
AP-FCT-64	150x100
AP-FCT-66	150x150

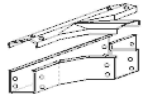

### Apex Front Cover Bend 90 Deg

Code	Size
AP-FCB90-33	75x75
AP-FCB90-44	100x100
AP-FCB90-64	150x100
AP-FCB90-66	150x150

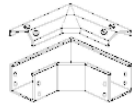

### Apex Front Cover Bend 45 Deg

Code	Size
AP-FCB45-33	75x75
AP-FCB45-44	100x100
AP-FCB45-64	150x100
AP-FCB45-66	150x150



## EXTERNAL COVER FITTINGS

### Apex External Cover Tee

Code	Size
AP-ECT-33	75x75
AP-ECT-44	100x100
AP-ECT-64	150x100
AP-ECT-66	150x150

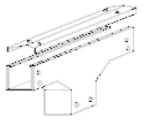

### Apex External Cover Bend 90 Deg

Code	Size
AP-ECB90-33	75x75
AP-ECB90-44	100x100
AP-ECB90-64	150x100
AP-ECB90-66	150x150



### Apex External Cover Bend 45 Deg

Code	Size
AP-ECB45-33	75x75
AP-ECB45-44	100x100
AP-ECB45-64	150x100
AP-ECB45-66	150x150

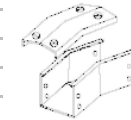

## INTERNAL COVER FITTINGS

### Apex Internal Cover Tee

Code	Size
AP-ICT-33	75x75
AP-ICT-44	100x100
AP-ICT-64	150x100
AP-ICT-66	150x150

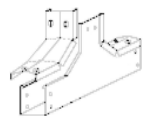

### Apex Internal Cover Bend 90 Deg

Code	Size
AP-ICB90-33	75x75
AP-ICB90-44	100x100
AP-ICB90-64	150x100
AP-ICB90-66	150x150

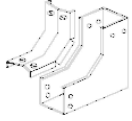

### Apex Internal Cover Bend 45 Deg

Code	Size
AP-ICB45-33	75x75
AP-ICB45-44	100x100
AP-ICB45-64	150x100
AP-ICB45-66	150x150

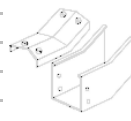

### Apex Flange Adaptor Fix Lid

Code	Size
AP-FA-FL-33	75x75
AP-FA-FL-44	100x100
AP-FA-FL-64	150x100
AP-FA-FL-66	150x150



### Apex Flange Adaptor Removable L

Code	Size
AP-FA-RL-33	75x75
AP-FA-RL-44	100x100
AP-FA-RL-64	150x100
AP-FA-RL-66	150x150



### Apex Square Reducer

Code	Size
AP-SQR-44-	100x100
AP-SQR-64-	150x100
AP-SQR-66-	150x150

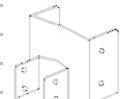

### Apex End Cap

Code	Size
AP-EC-33	75x75
AP-EC-44	100x100
AP-EC-64	150x100
AP-EC-66	150x150

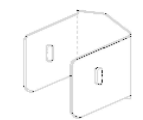

**Material Type: 304 Stainless Steel**  
**Material Finish: Satin**  
**Gauge: 1.2 mm (18G)**

# STAINLESS STEEL BRACKETS

## SPECIFICATIONS

Material Type: Stainless Steel 1.4301 - 304

Material Finish: 2B

Material Thickness: 1.2MM

### TRAY WALL BRACKET



Code	Size H x L
TWB-2	51mm x 51mm
TWB-3	51mm x 76mm
TWB-4	51mm x 102mm
TWB-6	51mm x 152mm
TWB-9	70mm x 230mm
TWB-12	94mm x 305mm
TWB-18	133mm x 460mm

### TRAY SUPPORT BRACKET



Code	Size H x L
TSB-3	28mm x 76mm
TSB-4	28mm x 102mm
TSB-6	28mm x 152mm
TSB-9	28mm x 230mm
TSB-12	28mm x 305mm
TSB-18	86mm x 460mm

### STIRUP HANGER BRACKET

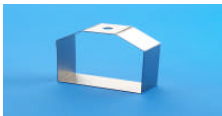

Code	For Wireway Size
SHB-2	50mm x 50mm
SHB-3	75mm x 75mm
SHB-4	100mm x 100mm
SHB-6	150mm x 150mm



### TRAY CHANNEL BRACKET

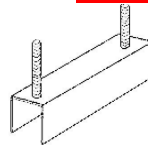

Code	Size
TCB-6	152mm
TCB-9	230mm
TCB-12	305mm
TCB-18	460mm

# STAINLESS STEEL PERFORATED WIREWAY SYSTEMS



### Perforated Wireway Standard Sizes

Code	Size	Length
WWP-22	50x50	3m
WWP-33	75x75	3m
WWP-44	100x100	3m
WWP-64	150x100	3m
WWP-66	150x150	3m

### Perforated Wireway Divider

Code	Size
WWP-33-D	75x75
WWP-44-D	100x100
WWP-66-D	150x150

**ONE STOP FOR ALL STAINLESS STEEL WIREWAY AND BESPOKE SOLUTIONS**

ZANARA USA  
1005 N. Commons Drive  
Aurora, Illinois 60504

Email: [sales@zanara.com](mailto:sales@zanara.com)

ZANARA UK  
3 Wellington Place  
Bletchley, Milton Keynes MK3 5NA

Email: [sales@zanara.com](mailto:sales@zanara.com)